

# LogiLink®

## LED Motion Sensor Strip

Art. No.: LED005



This battery powered motion sensing LED strip light is an easy way to illuminate your dark wardrobe, cupboards and underneath beds. No charging or wiring needed, just install the batteries, stick it on any place you want and turn the motion sensor on. Then the LED will activate via the motion sensor.

### Features:

- » Activates via motion sensor
- » Lights up when people get closed and automatically turns off 15seconds after no motion is detected
- » Easily use for lighting up inside wardrobes, cupboards, or underneath beds etc.
- » Powered by 4 AAA batteries (not included)
- » Easy to install; no charging or wiring needed
- » Lights will flash when there is not enough power to support it

### Article lamp photoelectric parameters:

Power (W)	LED Type	LED Qty (PCS/M)	Light Angle	CCT (K)	Luminous flux (lm)	CRI (Ra)	Strips Width	Strips length
2.4W	2835	30	120°	2700-6500	180±10%	>80	8mm	1M



Made in China



RoHS compliant



\* The specifications and pictures are subject to change without notice.  
\*All trade names referenced are the registered namework of their respective owners.

Best Connectivity

# LogiLink®

## LED Motion Sensor Strip

Art. No.: LED005



### Sensor technology parameters:

Working voltage	DC 6V
Surface color	Milky coating
Shell material	ABS
Induction lens size	Ø12.5mm
Induction distance	2-5M
Angle of induction	100°
Delay time	15 sec
Blocking time	0.2 sec
Static power	50µA
Triggered	Repeatable
Operation temperature	-20°C~+35°C
Storage temperature	-25°C~+55°C (25°C is best-fit)
The working life of the contact	200000 times
Product dimension	137 x 27 x 20mm



Made in China



RoHS  
compliant



\* The specifications and pictures are subject to change without notice.  
\* All trade names referenced are the registered trademark of their respective owners.



## Installation:

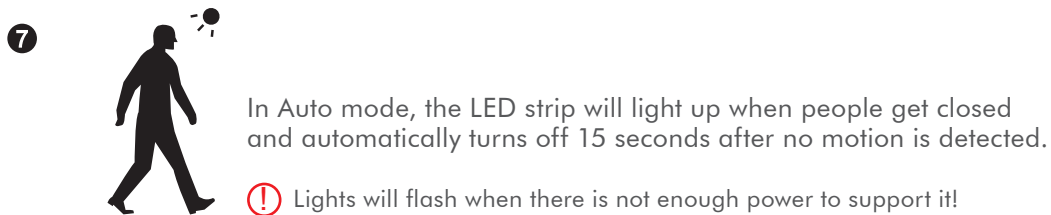
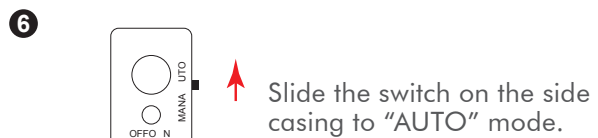
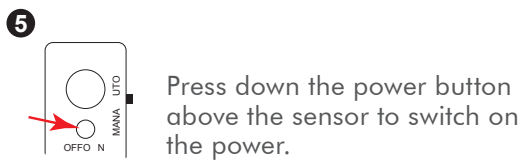
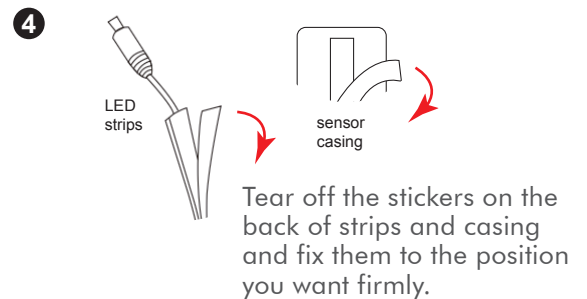
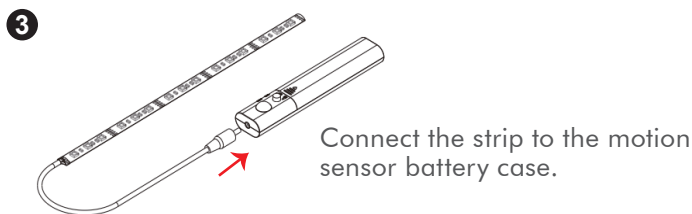
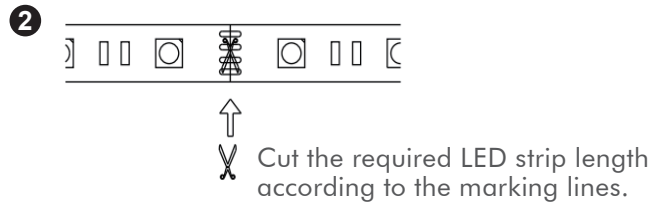
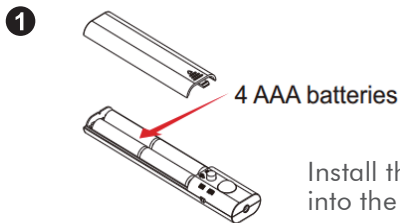

### Package Contents:

- » 1 x LED Motion Sensor Strip
- » 1 x User Manual

### Package Informations:

- » Packing Dimension: mm
- » Packing Weight: kg
- » Carton Dimension: 410 x 410 x 220mm
- » Carton Q'ty: pcs
- » Carton Weight: kg



\* The specifications and pictures are subject to change without notice.  
 \*All trade names referenced are the registered namework of their respective owners.



Made in China